

G16

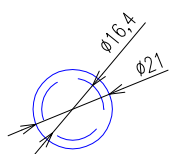

G22

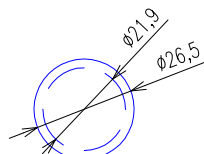

G28

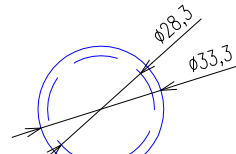

G36

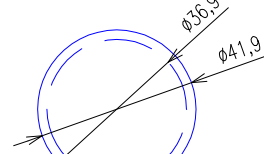

G42

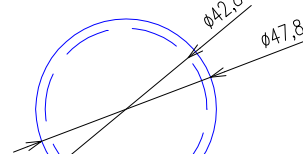

G54

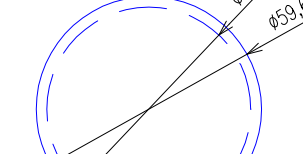

G70

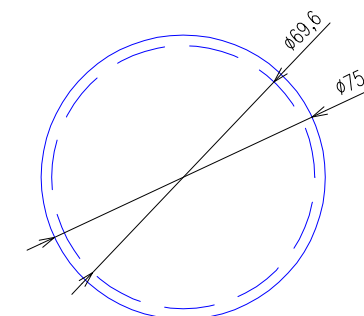

G82

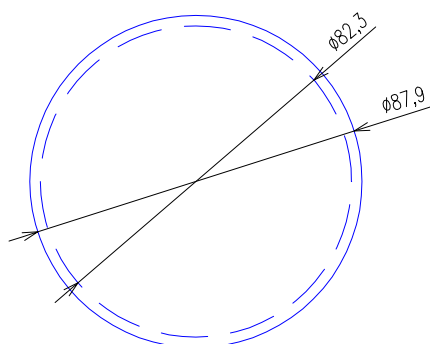

G92

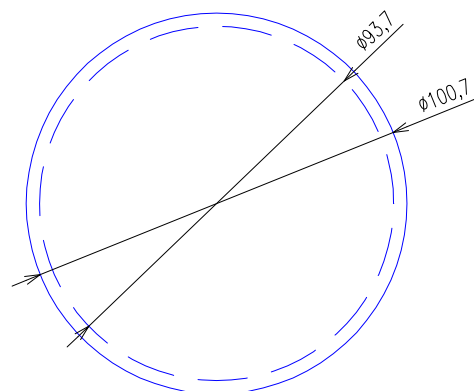

G104

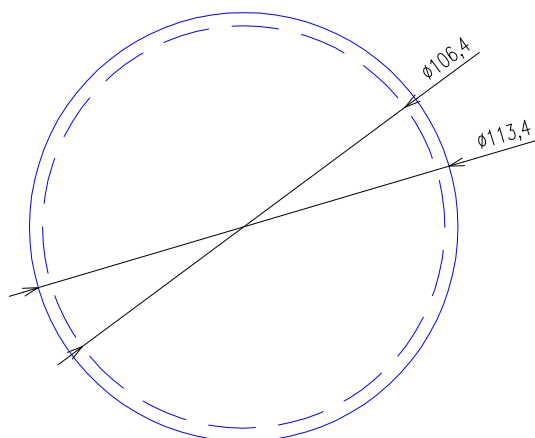

種類	(呼び径)	外径	内径	厚さ (mm)	断面積 (mm ²)
厚鋼電線管	G16	21.0	16.4	2.3	211
	G22	26.5	21.9	2.3	376
	G28	33.3	28.3	2.5	629
	G36	41.9	36.9	2.5	1069
	G42	47.8	42.8	2.5	1438
	G54	59.6	54.0	2.8	2289
	G70	75.2	69.6	2.8	3802
	G82	87.9	82.3	2.8	5317
	G92	100.7	93.7	3.5	6892
	G104	113.4	106.4	3.5	8886

E19

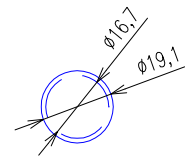

E25

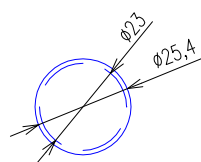

E31

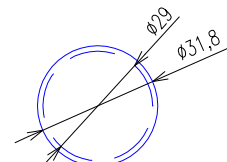

E39

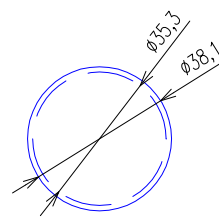

E51

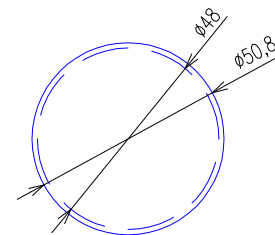

E63

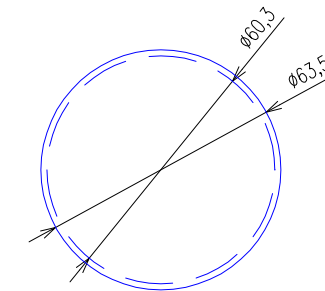

E75

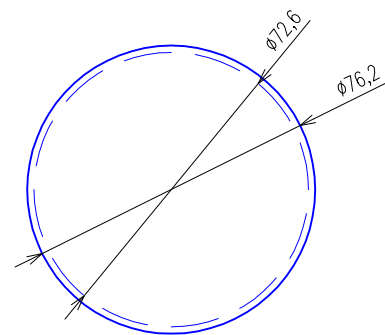

種類	(呼び径)	外径	内径	厚さ (mm)	断面積 (mm ²)
ねじなし電線管	E19	19.1	16.7	1.2	218
	E25	25.4	23.0	1.2	415
	E31	31.8	29.0	1.4	660
	E39	38.1	35.3	1.4	978
	E51	50.8	48.0	1.4	1808
	E63	63.5	60.3	1.6	2854
	E75	76.2	72.6	1.8	4137

VE14

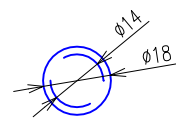

VE16

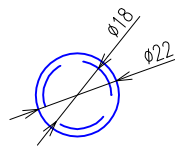

VE22

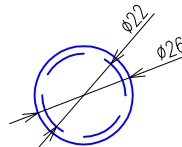

VE28

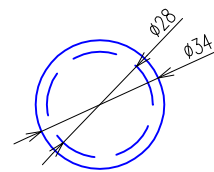

VE36

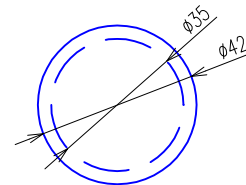

VE42

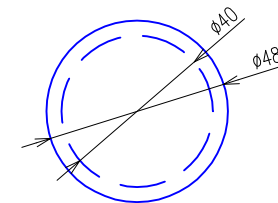

VE54

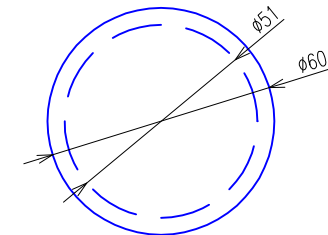

VE70

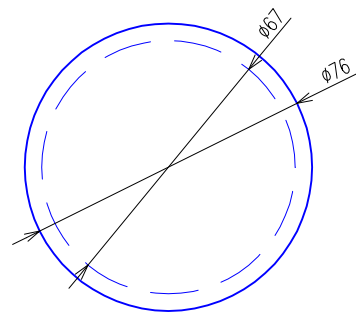

VE82

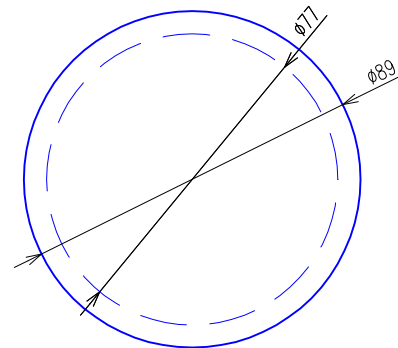

種類	(呼び径)	外径	内径	厚さ (mm)	断面積 (mm ²)
VE管・HIVE管	14	18	14.0	2.0	153
	16	22	18.0	2.0	254
	22	26	22.0	2.0	379
	28	34	28.0	3.0	615
	36	42	35.0	3.5	961
	42	48	40.0	4.0	1256
	54	60	51.0	4.5	2041
	70	76	67.0	4.5	3523
	82	89	77.0	5.9	4678

PF14

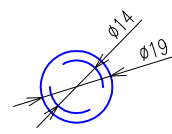

PF16

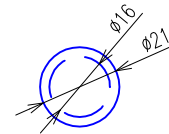

PF22

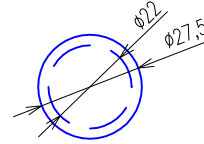

PF28

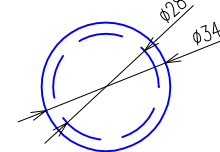

PF36

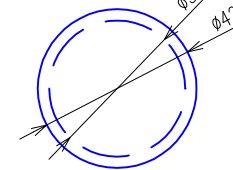

PF42

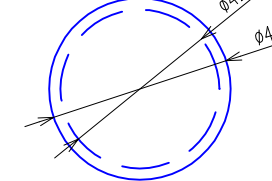

種類	呼び径	外径	内径	断面積 (mm ²)
PF管	14	19.0	14.0	153
	16	21.0	16.0	200
	22	27.5	22.0	380
	28	34.0	28.0	615
	36	42.0	36.0	1017
	42	48.0	42.0	1384

#10

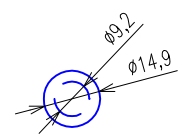

#12

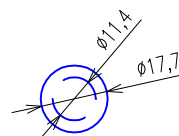

#15

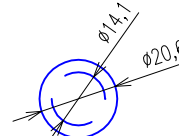

#17

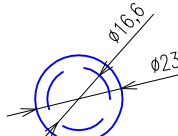

#24

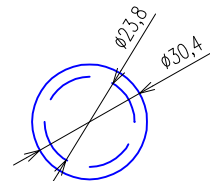

#30

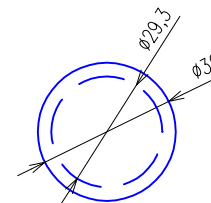

#38

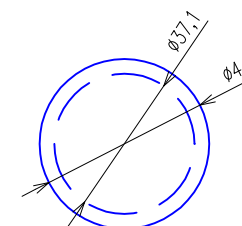

#50

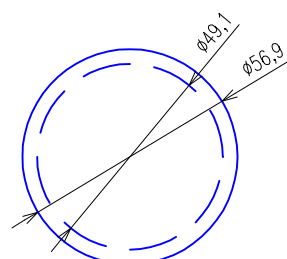

#63

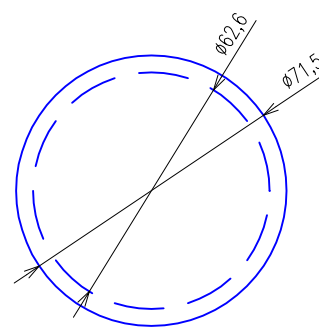

#76

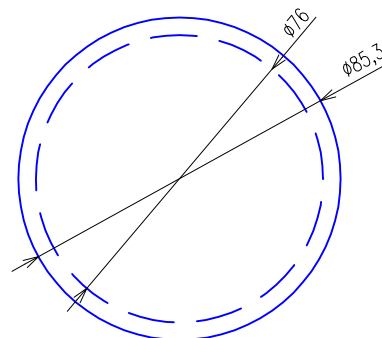

#83

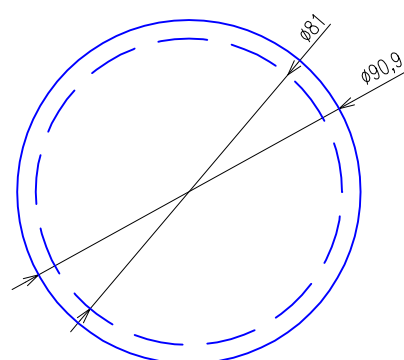

#101

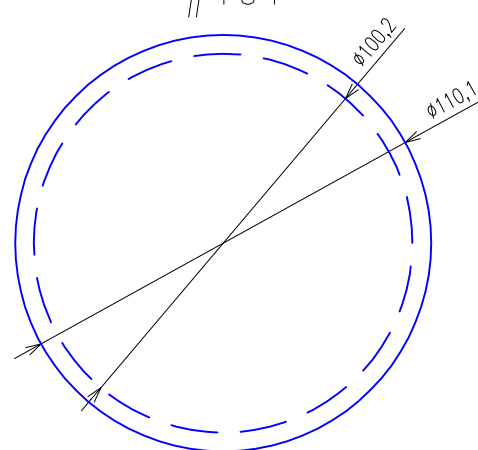

種類	呼び径	外径	内径	断面積 (mm ²)
2種金属製 可とう電線管	10	14.9	9.2	66
	12	17.7	11.4	102
	15	20.6	14.1	156
	17	23.1	16.6	216
	24	30.4	23.8	444
	30	36.5	29.3	673
	38	44.9	37.1	1080
	50	56.9	49.1	1892
	63	71.5	62.6	3076
	76	85.3	76.0	4534
	83	90.9	81.0	5150
	101	110.1	100.2	7881

MFX-22

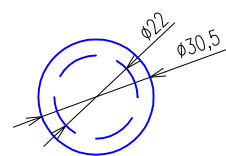

MFX-28

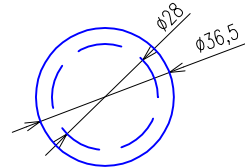

MFX-36

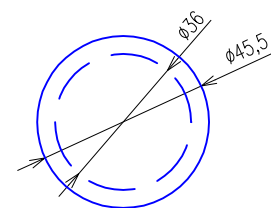

MFX-42

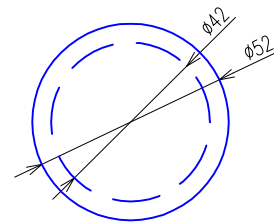

MFX-54

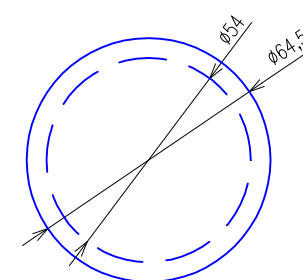

MFX-70

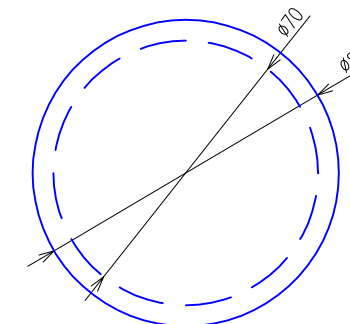

MFX-82

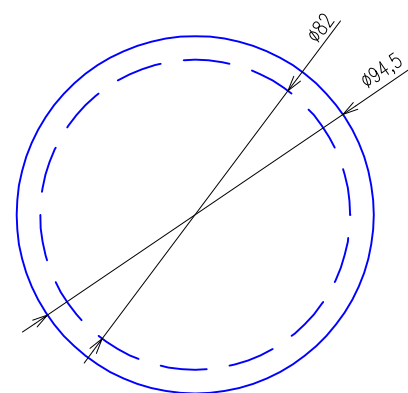

MFX-100

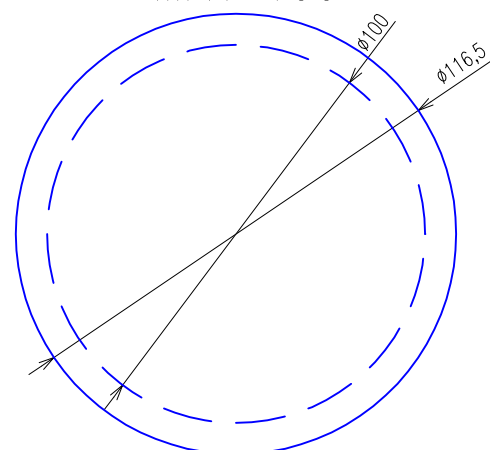

種類	呼び径	外径	近似内径	断面積 (mm ²)
ミラレックス MFX (地中埋設管)	22	30.5	22	380
	28	36.5	28	615
	36	45.5	36	1017
	42	52.0	42	1320
	54	64.5	54	2164
	70	81.0	70	3524
	82	94.5	82	4837
	100	116.5	100	7235

FEP-20

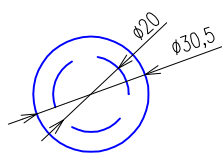

FEP-30

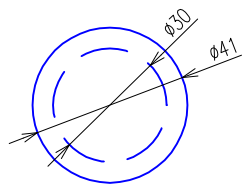

FEP-40

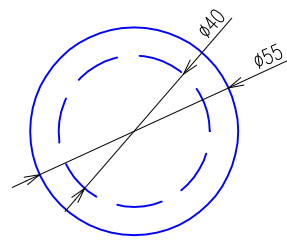

FEP-50

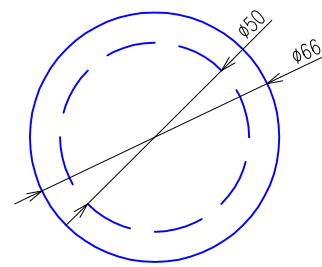

FEP-65

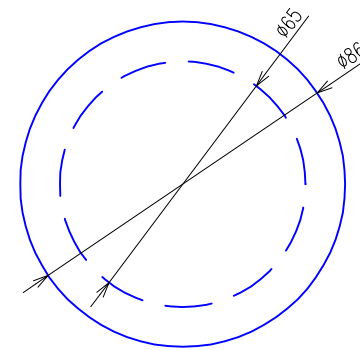

FEP-80

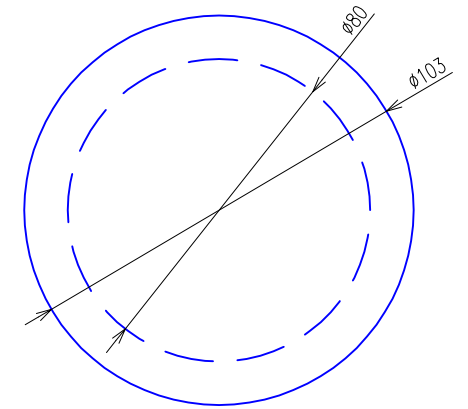

FEP-100

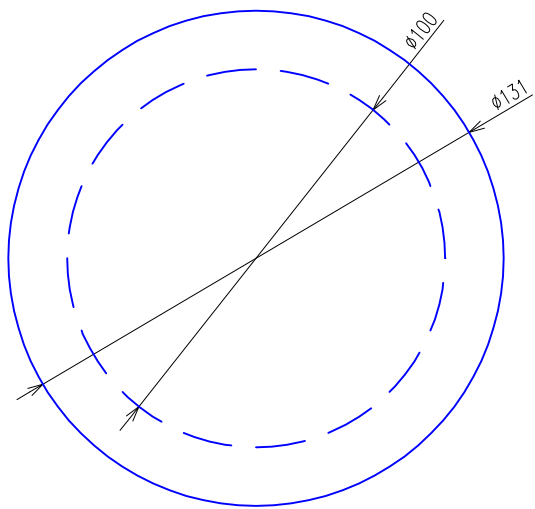

種類	呼び径	外径	近似内径	断面積 (mm ²)
ミラレックスF FEP (地中埋設管)	20	30.5	20	346
	30	41.0	30	707
	40	55.0	40	1256
	50	66.0	50	1963
	65	86.0	65	3317
	80	103.0	80	5024
	100	131.0	100	7850